

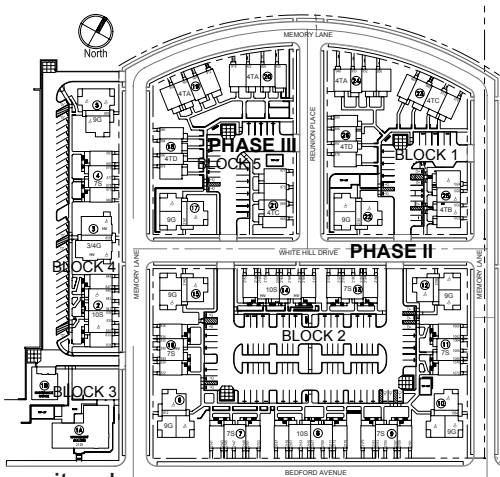

view down Bedford Avenue



site plan



9 unit building with accessible units on 1st floor



Phase II view on Bedford Avenue

Bedford Neighborhood, Hill District Pittsburgh, PA • 2008

204 mixed income housing in 28 low-rise apartment buildings and a community / management building to be located on a former public housing site. Developed by a private developer with PHFA tax credits, Phase II completed in Summer of 2008 while Phase III is scheduled to finish in 2009. All buildings are built to energy efficiency standard exceeding Energy Star.